

**CLARIDGE ASPIRE SERIES
FACTORY BUILT UNIT
TRIM SECTION DETAILS
SCALE=FULL SIZE**

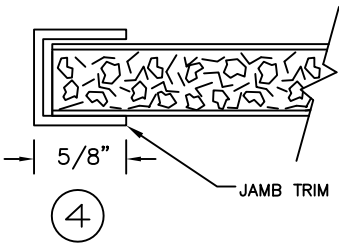

TYPICAL ELEVATION
NTS

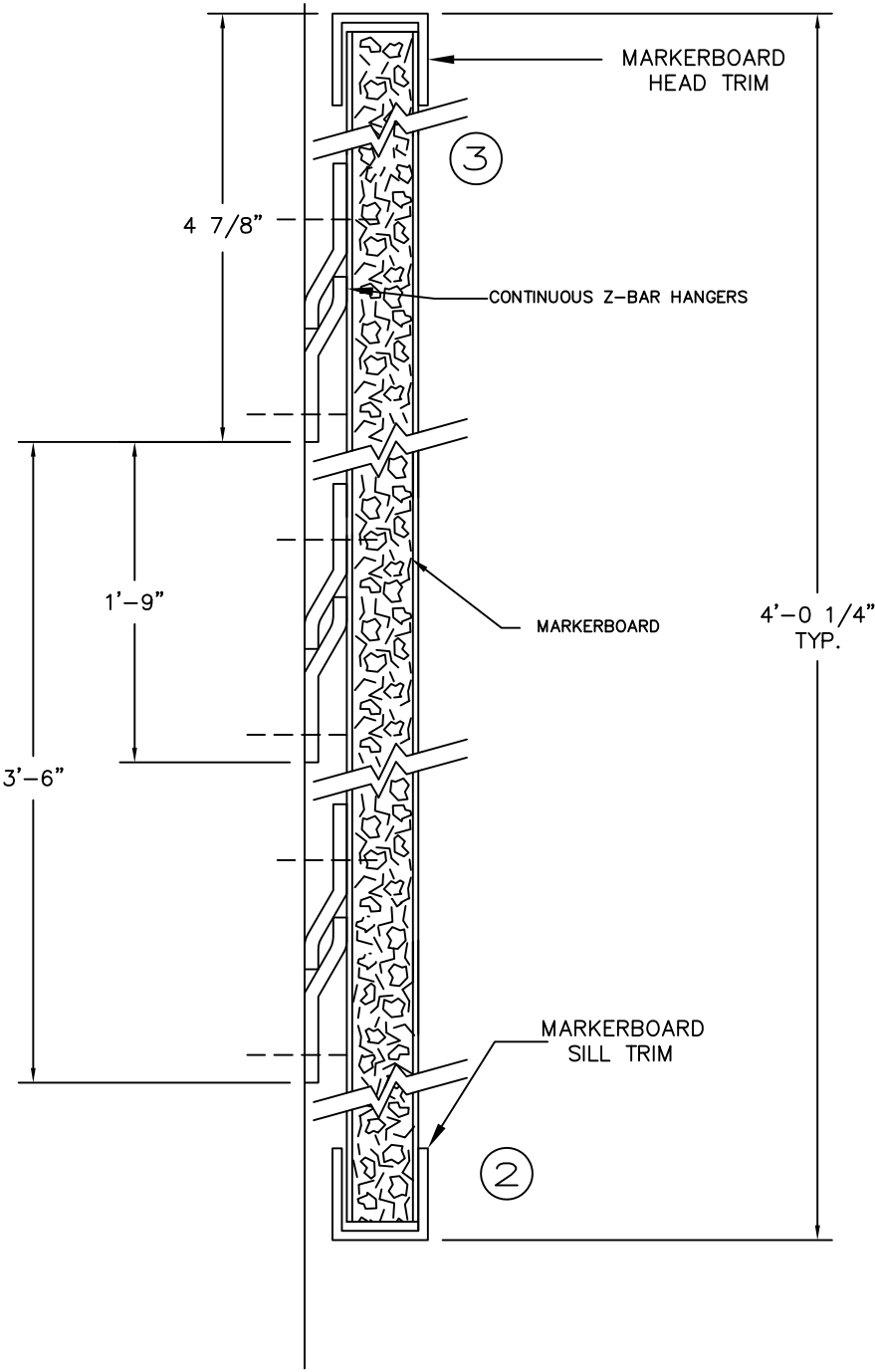
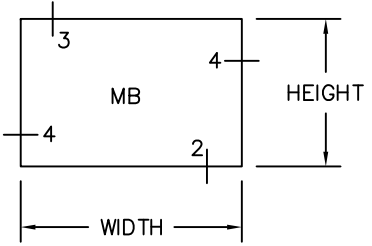

NOTES:
THIS IS A CLARIDGE ASPIRE SERIES FACTORY BUILT UNIT.
MB= LCS #100 WHITE ON 7/16" MDF W/ALUMINIZED STEEL BACKING, APPROX. 1/2" THICK OVERALL.
TRIM= EXTRUDED ALUMINUM WITH A CLEAR ANODIZED FINISH.
ALL DIMENSIONS ARE BOARD DIMENSIONS LESS TRIM, ADD 1/4" TO WIDTH AND HEIGHT FOR OVERALL SIZES INCLUDING TRIM.
NO SCREWS OR WALL ANCHORS INCLUDED.